

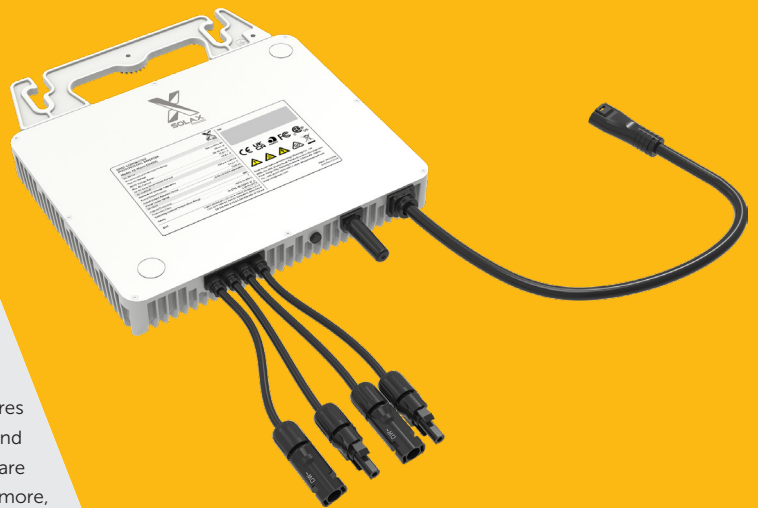

X1-Micro (2-in-1)

The Solax X1-Micro series is renowned for its exceptional power output, positioning itself as one of the top-rated models among 2-in-1 microinverters, boasting an impressive capacity of up to 1200 VA. Specifically designed to cater to the latest and previous generation of high-power modules, these microinverters feature two independent MPPTs and robust support for input current and output power. Seamlessly incorporating Wi-Fi wireless technology, the X1-Micro series ensures reliable and consistent communication, offering users a smooth monitoring and control experience. Delivering a cost-effective solution, these microinverters are highly suitable for both residential and commercial solar applications. Furthermore, they are fully compatible with the Solax Hybrid system and seamlessly integrate with various AC coupled systems available in the market, thus enhancing their versatility and adaptability.



**X1-Micro 800 / X1-Micro 900 /
X1-Micro 1000 / X1-Micro 1200**

Features

- Max output power up to 1200VA with two independent input channels(MPPT)
- Up to 20A DC input current to be compatible with the high power PV module
- Built-in industrial grade Wi-Fi module for high reliability
- Safety protection relay integrated
- Support micro-grid, AC coupling solution with existing storage system
- Support the integration of a single-phase microinverter into a three-phase power grid system
- With Reactive Power Control and Rapid Shutdown Function
- Easy to install and maintain with small size, light weight
- IP67 protection class, more reliable

Communication Diagram

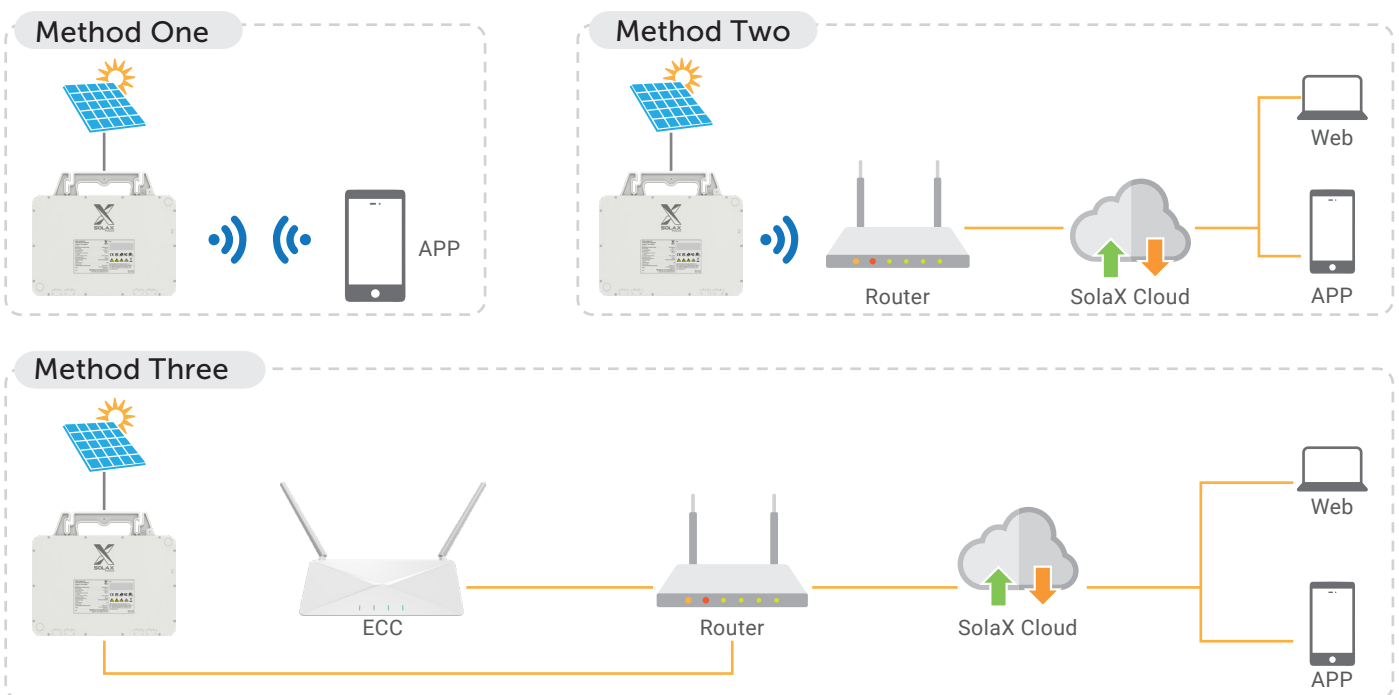

X1-Micro 800

X1-Micro 900

X1-Micro 1000

X1-Micro 1200

DC INPUT

Max. PV input power [W]	320 to 540+	360 to 600+	400 to 670+	400 to 670+
Max. PV input voltage [V]			60	
MPPT voltage range[V]			22-60	
Start-up voltage [V]			20	
Max. PV input current[A]	2 × 15A	2 × 16A		2 × 20A
Max. input short circuit current I _{sc} [A]	2 × 20A	2 × 25A		2 × 30A
No. of MPP trackers			2	
Strings per MPP tracker			1	

AC OUTPUT

Rated AC output power [VA]	800	900	1000	1200
Rated grid voltage/range[V]			220 or 230 or 240 / 180-275	
Rated AC output current [A]	3.64 / 3.48 / 3.33	4.09 / 3.91 / 3.75	4.55 / 4.35 / 4.17	5.45 / 5.22 / 5.00
Nominal AC frequency/range [Hz]			50 / 45-55 or 60 / 55-65	
Maximum units per branch 25A	6 / 7 / 7	6	5	4 / 4 / 5
Power Factor range (adjustable)			>0.99(-0.8~0.8 adjustable)	
THDi (Rated power) [%]			< 3%	

Efficiency

Max. efficiency			96.50%	
Nominal MPPT efficiency			99.9%	
Night power consumption [mW]			< 40	

STANDARD

Safety	IEC62109-1/-2, IEC61000-6-1/-2/-3-4, IEC61000-3-2, IEC61000-3-3, IEC 61727, IEC 62116, IEC 61683			
Grid Connection Standard	EN50549-1:2019, VDE-AR-N 4105: 2018, VFR 2019, RD1699:2011, CEI 0-21:2019, ABNT NBR 16149, ABNT NBR 16150, AS/NZS 4777.2:2015			

ENVIRONMENT LIMIT

Ingress protection rating			IP67 (NEMA 6)	
Operating ambient temperature range [°C]			-40 ~ 65°C	
Humidity[%]			0 ~ 100(condensing)	
Storage temperature[°C]			- 40°C ~ 65°C	

GENERAL

Dimension(W x H x D) [mm]			260 × 210 × 40	
Weight [kg]			3.1	
Cooling concept			Natural convection	
Communication			Built-in Wi-Fi	
Monitoring			Solax Cloud	