



Fresh-r

Smart indoor
air care

Fresh-r Compact In-the-Wall Specifications and Data

Smart measurement and control technology that reuses heat in the winter and coolness in the summer.

Keeps it comfortable indoors and the air healthy, without losing energy.

Demand-driven and balanced HR ventilation without ducts.

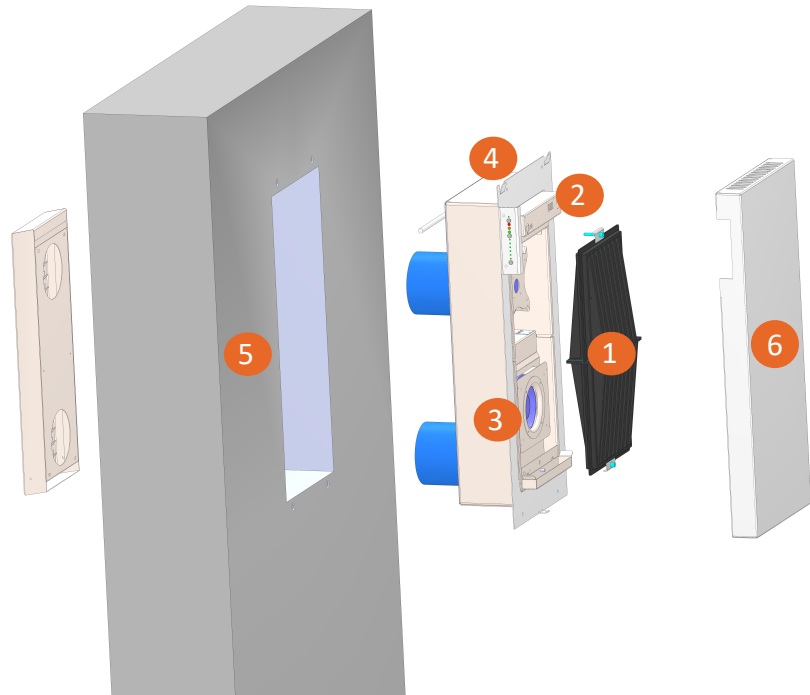

Key Features

- 1 The heat exchanger is made of copper, that conducts heat 1000 times better than polyethylene, of which other heat exchangers are made. Therefore temperature is exchanged from the outgoing air to the incoming air in a much shorter air path, which has multiple advantages:
 1. Keeps the unit compact;
 2. Low pressure drop, resulting in low fan energy usage and very low noise levels;
 3. Sub-zero efficiency;
 4. A thermal efficiency of 90% at 60 m³ / hour.
- 2 Air quality is monitored by CO₂ sensor and humidity sensor.
- 3 Ventilators refresh the indoor air, with a capacity of up to 90 m³ per hour.
- 4 Wi-Fi antenna sends collected data, for online insights in performance.
- 5 Can be installed both onto as well as into the outside wall.
- 6 Circular design and all parts are easily accessible through a sound-insulated door. There are no filters that need to be replaced (semi-)annually; low maintenance costs.



3 year warranty when Wi-Fi connected. 2 year without Wi-Fi connection.



World champion
in ventilation

TECHNEA | 
Wijzer in woningtechniek

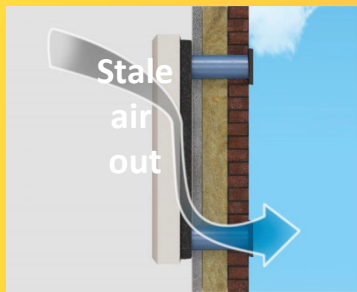

Fresh-r is like a breathing window



Fresh-r

Smart indoor air care



Pallasweg 13
8938 AS Leeuwarden
058 - 288 47 39
www.technea.nl
info@technea.nl

Technical Data

Heat exchanger	Copper wire
HE efficiency	90 % *
ErP label	A+
Controls	CO ₂ / RH / Temp.
Balanced	Yes
Mounting	In the wall or On the wall
Outside duct diameter	100 mm duct, 130 mm incl. insulation sleeve
Extract duct connection	In next model
Condensate discharge	Integrated in exhaust
Electricity supply	230v/1ph/50Hz
Max power consumption	25 Watts total
Average power consumption	10 Watts total
Wi-Fi inside	Yes
Filter class	M5 standard F7 in next model
Dimensions (H x W x D in mm)	
- On the wall	638 x 284 x 192
- In the wall body	638 x 284 x 134
- In the wall door	725 x 326 x 58

* Test at norm volume of 60 m³/hr and 87 % at 80 m³/hr performed by BRE UK

Air flow control

The Fresh-r saves 35% (avg.) on the overall ventilation energy by only ventilating when needed. The air flow rate is automatically adjusted to keep air quality good. CO₂ and RH sensors with its smart control are always included in the Fresh-r and are situated in the outgoing air stream. The automatic mode can manually be overruled by increasing / decreasing fan speed. The user interface indicates the air quality level in 3 steps with icons for good, medium and bad.

Air balance control

Two backward curved fans are continuously balanced. This worldwide patented system enables very direct balance control, also with strong winds.

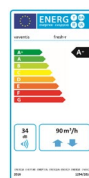

Flow & electricity

25 m ³ / hr (7 l/s)	5.3 Watt
53 m ³ / hr (15 l/s)	11.7 Watt
76 m ³ / hr (21 l/s)	17.6 Watt

Testing by BRE planned for SAP Appendix F. To be certified as Passive House component.

Flow & sound

35 m ³ / hr (7 l/s)	25 dB(A)
65 m ³ / hr (15 l/s)	30 dB(A)
80 m ³ / hr (21 l/s)	35 dB(A)

NEN-EN-ISO 3741 tested by Cauberg-Huygen

Pressure Flow Graph

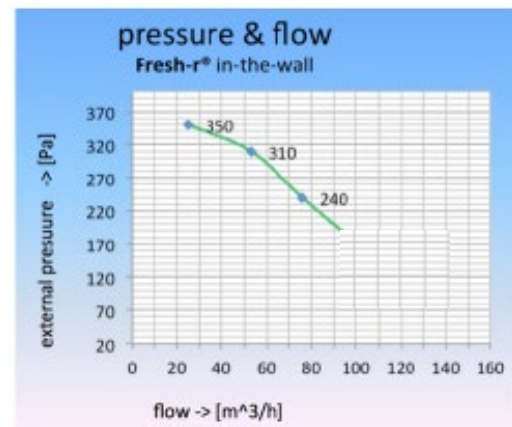

Minimised cold bridge

The cold side of the Fresh-r is completely separated from the warm side.

Fresh-r, Vaventis BV reserve the right, in the interests of continuous development, to alter specifications without prior notice. All orders are accepted subject to our conditions of sale which are available on request.