

WOODCO

Heat and Power

E-COMPACT TWIST®

25 - 100kW HE

Condensing Pellet Boiler

103%

Efficiency

Available in a wide range of outputs

25kW → 100kW

Spiral heat exchanger
(patent granted)



Most Powerful Range of Condensing Pellet Boilers in the World

New for
2016



i-Gen Controller

The ultimate in boiler control, the i-Gen enables 'out of the box' installation with fuzzy logic PID control, meaning the commissioning process is greatly simplified. Combined with Smart Technology.

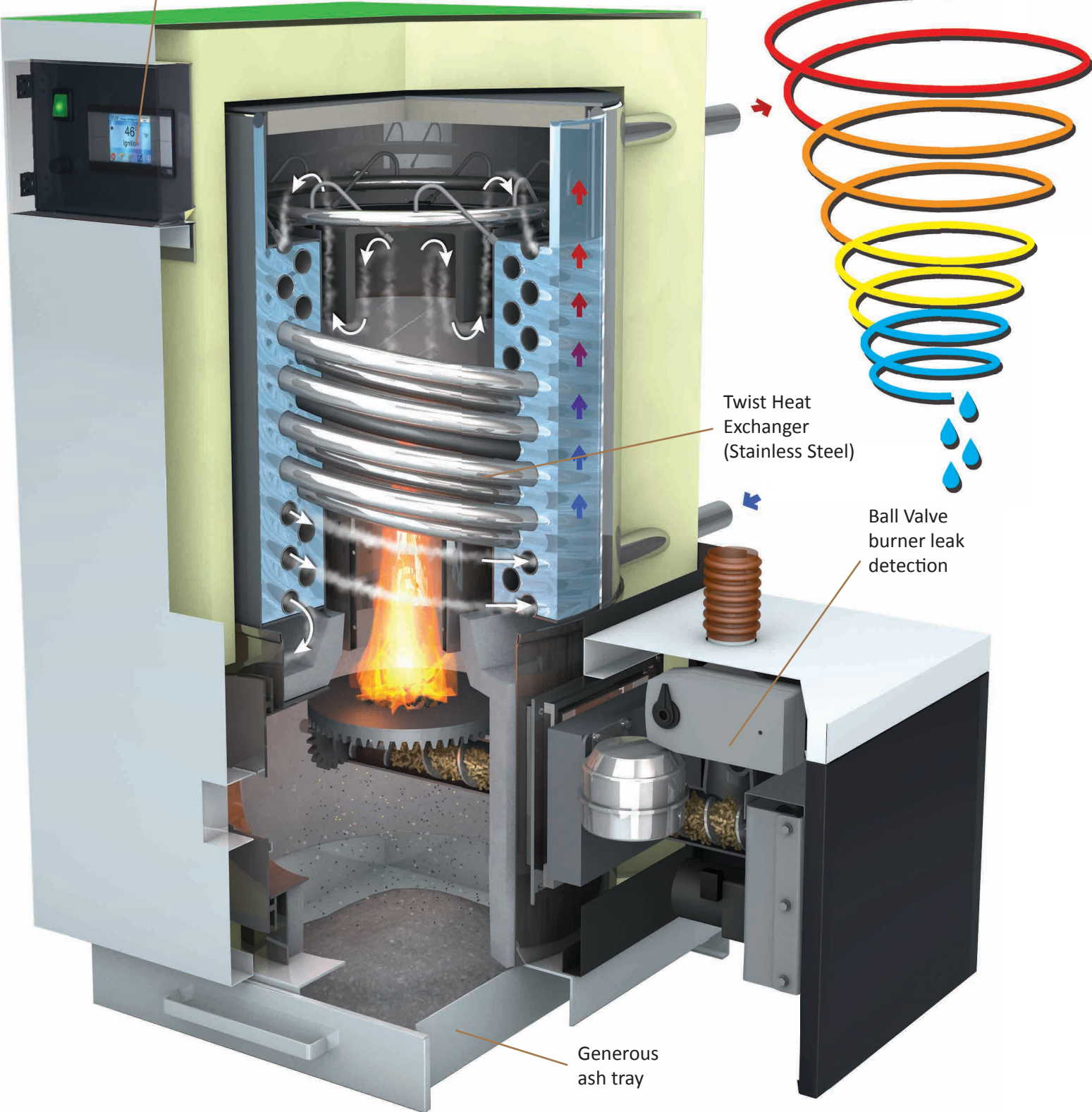

Twist Heat
Exchanger
(Stainless Steel)

Ball Valve
burner leak
detection

Generous
ash tray

2016 sees WOODCO introduce the E-COMPACT HE models. With its unique patented heat exchanger and burner design they are truly the most advanced biomass boilers on the European market today.



Stunning performance

- Condensation technology
- Unbeatable efficiency
- Optimal energy transfer
- Lowest emissions
- Wide temperature range
- Unique biomass boiler with spiral heat exchanger (patented)

Outstanding equipment

- Stainless steel heat exchanger (single)
- Lambda probe (optional)
- Automatic feeding system
- Spacious removable ash drawer
- i-Gen Controller
- Exchanger automatic cleaning
- Burner plate smart cleaning
- Automatic ignition system



i-Gen Features

- Remote monitoring (and control) facility
- 7 day programmer
- Monitoring report logs via e mail
- Comprehensive reports menu e.g. fuel usage report
- Easy to understand graphics
- Simple to operate in bright colour
- Low fuel level warning
- Notification to clean ash pan and service boiler



Technical specifications

Automatic auger
feeding

1

Bag filling integral
hopper

2

Automatic vacuum
suction feeding

3

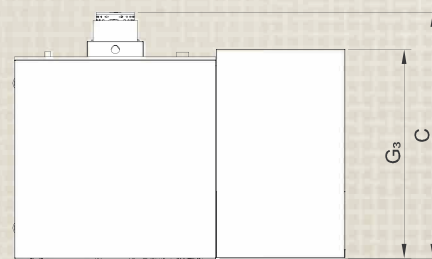
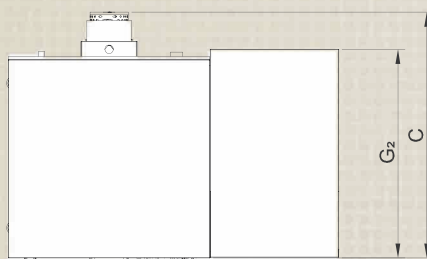
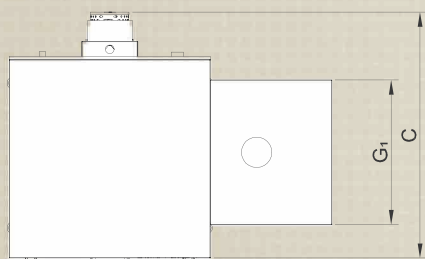
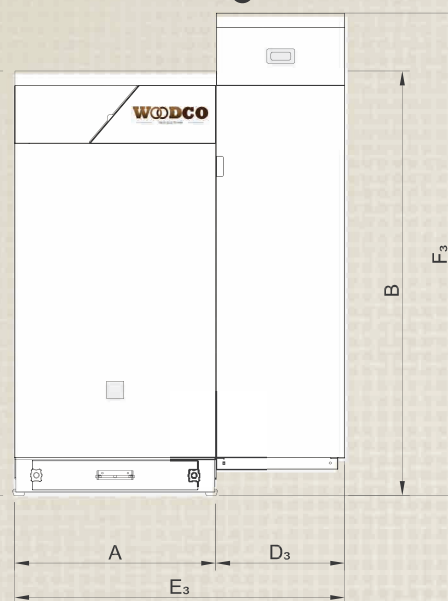
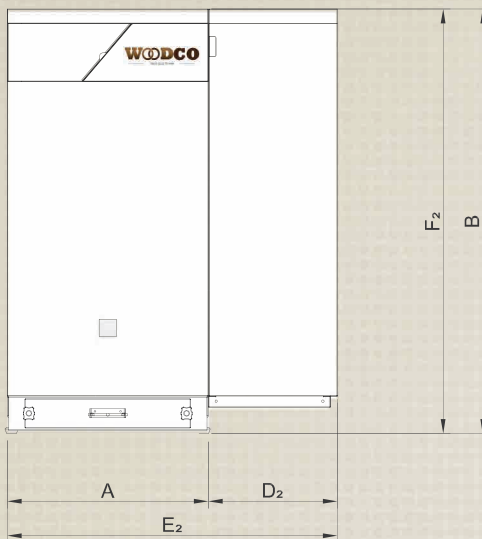
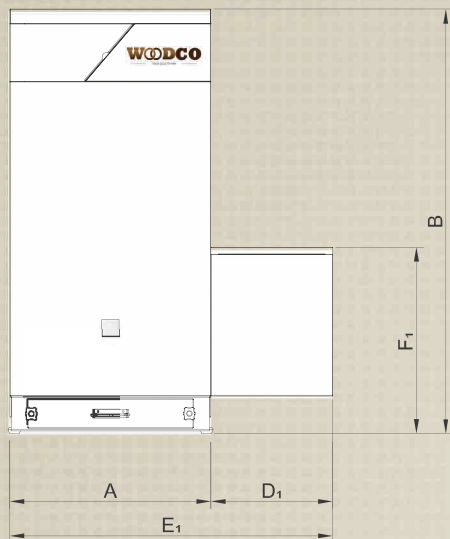

Model		TWIST 25	TWIST 30	TWIST 40	TWIST 50	TWIST 70	TWIST 100
Boiler Rated Output	kW	7.5 - 25	9 - 30	12 - 40	15 - 50	19 - 70	30 - 100
Efficiency at nominal/reduced output	%	101.5 / 100.5	101.5 / 100.5	100.6 / 98.5	102.0 / 97.7	101.7 / 97.7	105.3 / 101.8
Flue Gas Manometric Pressure at nominal/reduced output	Pa	8 / 5	8 / 5	8 / 5	8 / 5	8 / 5	8 / 5
Flue Gas temp at nominal/reduced output	°C	50 / 38	48 / 38	46 / 39	44 / 40	45 / 41	39 / 37
Water Capacity	l	78	78	78	78	112	213
Operating Temperature	°C	27 - 80	27 - 80	27 - 80	27 - 80	27 - 80	27 - 80
Maximum Operating Pressure	bar	3	3	3	3	3	4
Water flow/return connection	"GAS/M	1½"	1½"	1½"	1½"	1½"	2"
Water drain connection	"GAS/M	½"	½"	½"	½"	½"	¾"
Flue gas pipe diameter	mm	150	150	200	200	200	200
Total dry weight 1 2 3	kg	385/425/445	385/425/445	415/465/485	415/465/485	415/*/485	550/*/620
Dimension A	mm	695	695	695	695	695	845
Dimension B	mm	1465	1465	1665	1665	1665	1765
Dimension C	mm	850	850	850	850	850	1105
Dimension D1/D2/D3	mm	420/446/446	420/446/446	420/446/446	420/446/446	420/*/446	420/*/446
Dimension E1/E2/E3	mm	1115/1141/1141	1115/1141/1141	1115/1141/1141	1115/1141/1141	1115/*/1141	1265/*/1291
Dimension F1/F2/F3	mm	645/146/1665	645/146/1665	645/146/1665	645/146/1665	645/*/1665	600/*1665
Dimension G1/G2/G3	mm	500/720/720	500/720/720	500/720/720	500/720/720	500/*/720	525/*/720
EN 303-5:2012	Class	5	5	5	5	5	5

E-COMPACT Boilers work best with ENplus A1 sealed pellets, under EN14961-2 standards
*Hopper not available for outputs higher than 50 kW



Head Office: WoodCo Energy SA,
Rte de Courgenay 38, 2900 Porrentruy, Switzerland.
t: +41 324668008

WoodCo Energy Ireland
Unit D Cahir Business Park, Cahir, Co. Tipperary, Ireland.
t: +353 52 7445330

w: www.woodco-energy.com

e: info@woodco-energy.com

MANUFACTURERS OF RENEWABLE HEATING PRODUCTS